

Conical Bottom-Shaped Tank

CONA-E

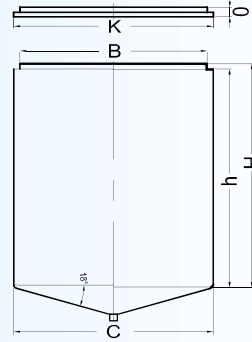

TIS 1379-2551



Tank							Lid				Approx. Total Weight (kg)
Part Number	Capacity (Litre)	Approx. Dimension (mm)					Part Number	Approx. Dimension (mm)			
		B	C	H	h	Thk.		K	O	Thk.	
CONA100E-M6x6	100	440	500	590	565	4.0	CN0435B-M1X8	590	50	3.0	5.50
CONA100E-M117						4.5					6.00
CONA100E-M8X6						5.5					7.50
CONA100E-M0X6						7.0					9.50
CONA200E-M9X2	200	595	650	680	660	4.0	CN0590B-M2X5	590	50	3.0	9.50
CONA200E-M9X5						4.5					9.80
CONA200E-M122						5.5					12.50
CONA200E-M124						7.0					14.40
CONA500E-M129	500	780	870	920	875	5.0	CN0760B-M2X9	760	75	2.5	19.30
CONA500E-M132						6.0					22.50
CONA500E-M138						8.0					29.10
CONA500E-M145						10.0					35.30
CONA1K0E-M130	1,000	960	1,030	1,415	1,370	6.0	CN0940B-M4X8	940	95	3.0	32.60
CONA1K0E-M145						7.0					37.20
CONA1K0E-M149						8.0					41.70
CONA1K0E-M159						10.0					51.20
CONA1K5E-M154	1,500	1,230	1,300	1,300	1,260	6.0	CN1220B-M6X9	1,220	90	3.5	48.50
CONA1K5E-M161						7.0					55.40
CONA1K5E-M168						8.0					62.30
CONA1K5E-M189						10.0					76.00
CONA2K0E-M164	2,000	1,220	1,300	1,700	1,660	6.0	CN1220B-M6X9	1,220	90	3.5	58.60
CONA2K0E-M172						7.0					67.10
CONA2K0E-M181						8.0					75.70
CONA2K0E-M198						10.0					92.70
CONA2K5E-M160	2,500	1,200	1,300	1,940	1,900	6.0	CN1220B-M6X9	1,220	90	3.5	64.70
CONA2K5E-M170						7.0					74.30
CONA2K5E-M189						8.0					83.70
CONA2K5E-M109						10.0					103.50
CONA3K0E-M184	3,000	1,200	1,300	2,440	2,400	6.0	CN1220B-M6X9	1,220	90	3.5	73.70
CONA3K0E-M196						7.0					85.70
CONA3K0E-M205						8.0					96.70
CONA3K0E-M231						10.0					120.70
CONA4K0E-M224	4,000	1,500	1,600	2,210	2,160	8.0	CN1520E-M122	1,520	310	4.5	126.00
CONA4K0E-M248						10.0					148.00
CONA4K0E-M263						11.0					163.00
CONA4K0E-M288						13.0					188.00
CONA4K0E-M396						15.0					216.00
CONA6K0E-M279	6,000	1,750	1,850	2,400	2,460	9.0	CN1750E-M126	1,750	345	4.5	175.00
CONA6K0E-M206						11.0					210.00
CONA6K0E-M349						13.0					245.00
CONA6K0E-M377						15.0					281.00
CONA10KE-M301	10,000	2,000	2,100	3,240	3,320	11.0	-	-	-	-	290.00
CONA10KE-M453						13.0					342.00
CONA10KE-M406						15.0					395.00
CONA10KE-M557						17.0					446.00
CONA10KE-M583						18.0					472.00